

Neop | Tubular work surfaces 600 Depth with or without sink

Care preparation plan or administrative work plan

- Essential element for nursing room arrangement
- Excellent stain resistance: to liquids, fluids, chemicals
- Thermoformed resin sink: easy cleaning
- One-piece manufactured drip tray
- Covered backsplash for easy washing
- Lab edge for water retention



Robust



Hygienic



Ergonomic

- Work surface with or without built-in sink
- Sink located on right or left side
- Fixed version or mobile version on wheels
- Resin or compact laminated work surface
- With or without backsplash version
- 2 or 3 possible Neop hanging storage units, with 80 cm height and 600 mm depth (please see corresponding data sheet)



Tubular work surface selection

Selection of base, work surface and wheel kit for mobile version, or jack foot kit for fixed version

Base

Base for 2 storage units	Base for 3 storage units
8Y606	8Y607

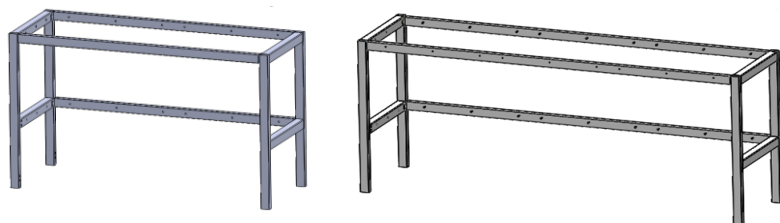

Work surface

		Work surface for 2 storage units	Work surface for 3 storage units
Made of compact laminate	With backsplash	8Y603	8Y605
	Without backsplash	8Y602	8Y604

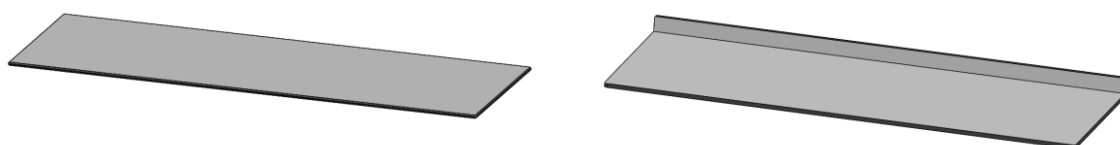

		Work surface for 2 storage units	Work surface for 3 storage units
Made of resin	With backsplash	8Y600	8Y601
	With backsplash and sink on right side	8Y600CD	8Y601CD
	With backsplash and sink on left side	8Y600CG	8Y601CG

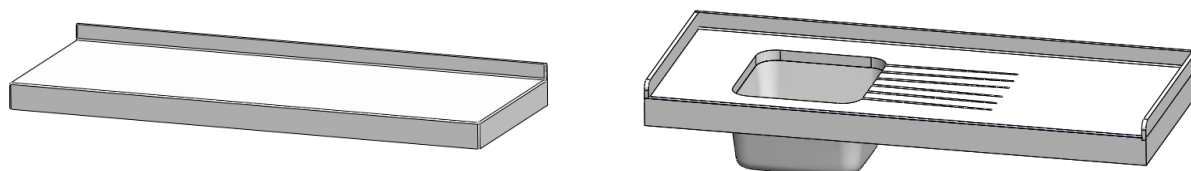

Wheel or jack foot kits

	Work surface for 2 storage units	Work surface for 3 storage units
Wheel kit compatible with laminate work surfaces	8Y400_R	8Y400_R
Jack foot kit compatible with resin and laminate work surfaces	8Y400_V	8Y400_V



Technical data for work surface without sink

2- module work surface F400

made of Acrylic resin with backsplash and jack feet

3- module work surface F400

made of compact laminate with backsplash and Jack feet

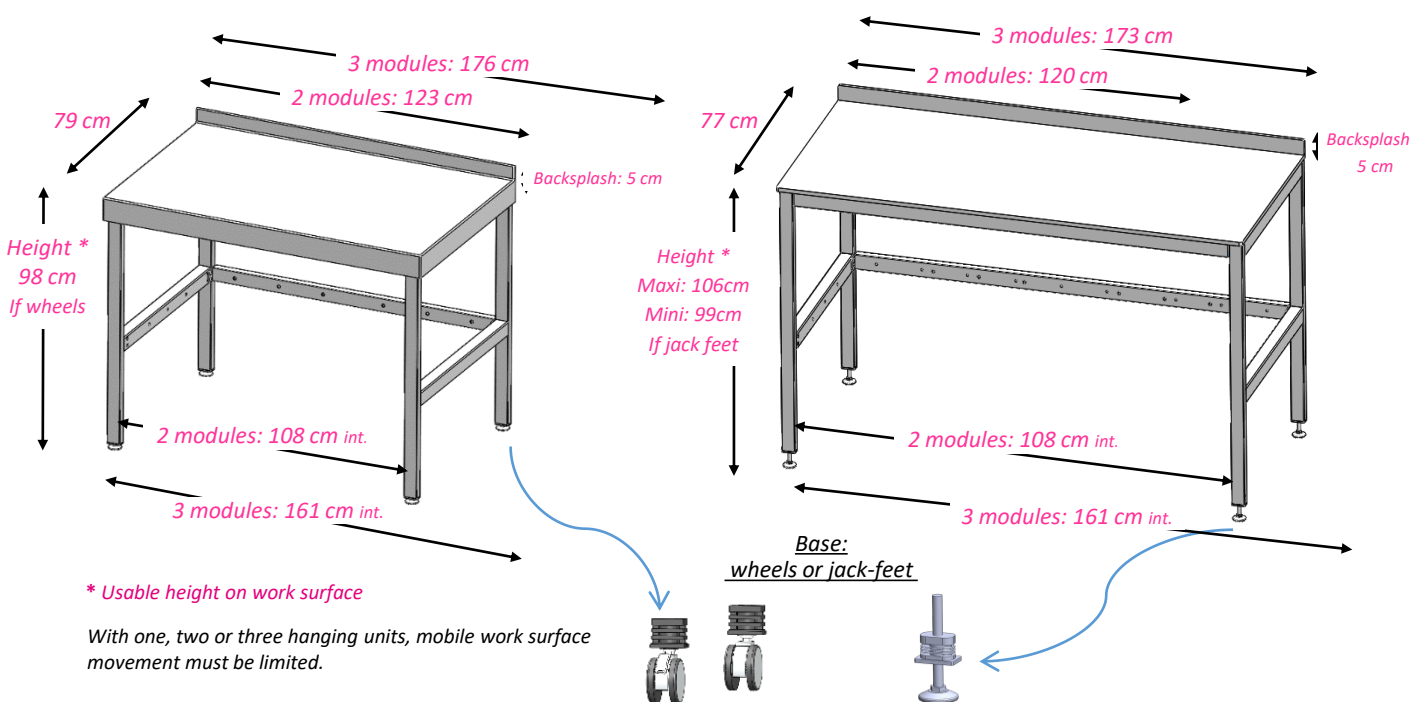

Materials

Structure	50*30 mm rectangular tubular structure made of EPOXY anti-corrosion treated steel
Work surface	Compact laminate 10 mm thickness or acrylic resin 13 mm thickness, with or without backsplash
Wheels	Double PolyAmide (PA) tread –Flexible PolyURethane tape (PUR) - steel ball bearings
Jack feet	PolyPropylene (PP) + galvanized steel

Additional information

Wheels and feet	Wheels: 65 mm diameter - double running – 4 swivelling (2 breaking wheels) Jack-foot: M10x120 mm, adjustable up to 7 cm maximum
Empty weight	With compact laminate work surface: 43 kg (2 modules) and 51 kg (3 modules) With acrylic resin work surface: 65 kg (2 modules) and 85 kg (3 modules)
Loading capacity	300 kg at total, for all models

Packaging

Packing	Individually on pallet strapped and film-wrapped, or on wheels with proper protection	Dimensions L X D x H	2 modules: 220 x 90 x 110 cm 3 modules: 220 x 90 x 110 cm
Gross weight (work surface + packaging)	Compact laminate work surface: 54 kg (2 modules) 60 kg (3 modules) Acrylic resin work surface: 76 kg (2 modules) 94 kg (3 modules)	Volume	2 modules: 2,2 m ³ 3 modules: 2,2 m ³

Technical data for work surface with sink

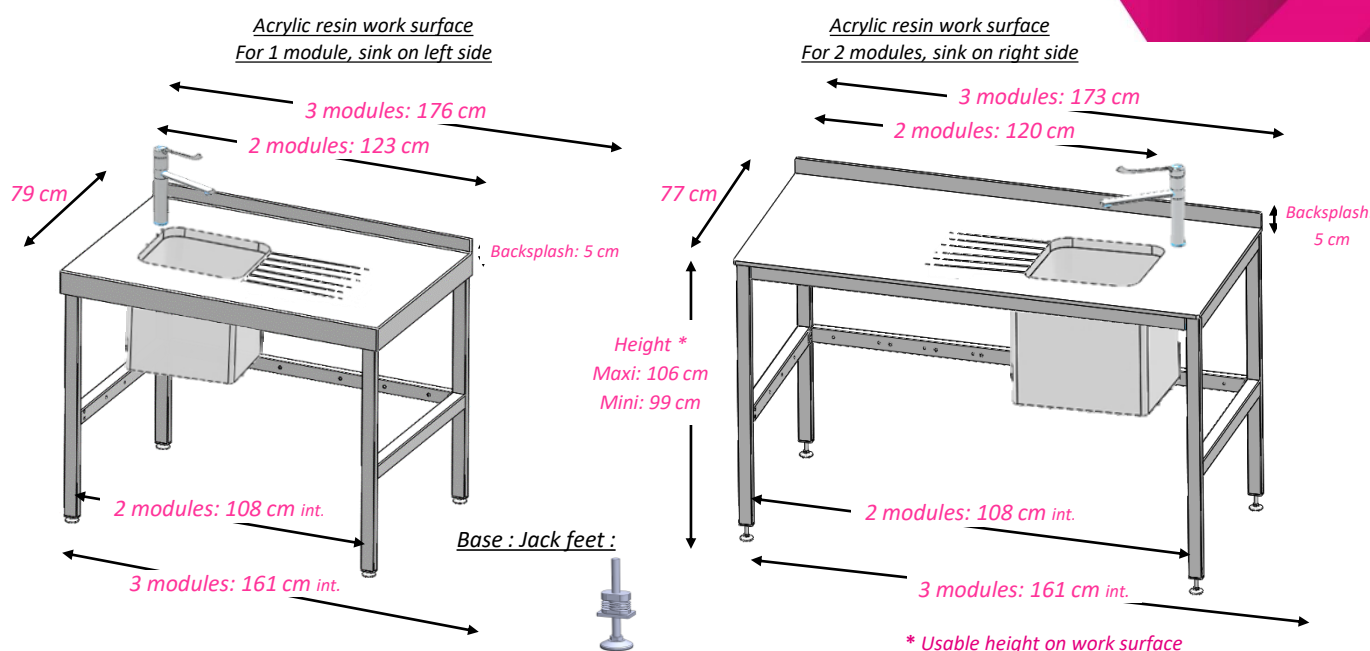

In option: left sink or right sink

Hanging units are not included: Please refer to technical data sheet "Neop hanging units" and "Neop mobile units"

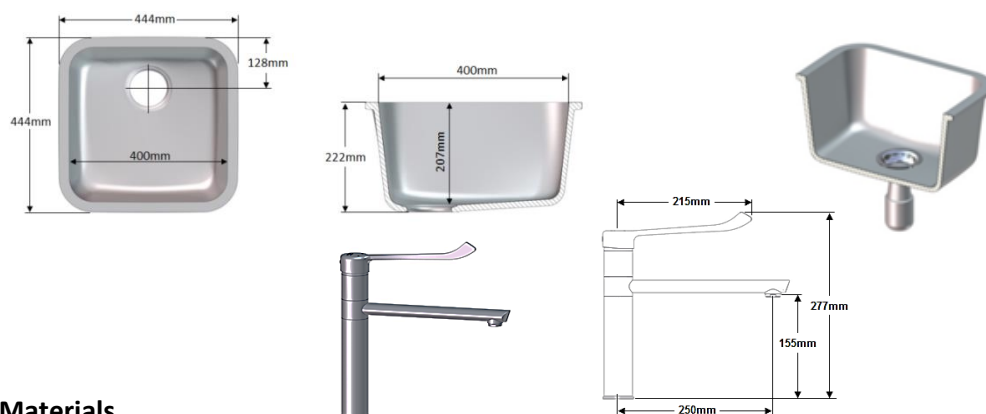

Materials

Structure	50*30 mm rectangular tubular structure made of EPOXY anti-corrosion treated steel.
Work station and sink	Acrylic resin 13-mm thickness, with chipboard panel thickness: 19 mm
Jack feet	Polypropylene (PP) + galvanized steel

Additional Information

Work station	3-side backsplash, drip tray - Lab edge on front side for water retention H 8 mm Total height: 32 mm – Sink cover, adjustable drain plug and pipe included.
Feet	Jack foot : M10x120 mm, adjustable up to 7 cm maximum
Empty weight	With acrylic resin work surface: 68 kg (2 modules) and 87 kg (3 modules)
Mixer tap	Hospital model with swivel spout - Lgth: 250 mm
Loading capacity	300 kg at total for all models

Packaging : please refer to technical data sheet for work surface without sink

Net weight	76 kg (2 modules) 94 kg (3 modules)
------------	--