

# ▶ C2S PRO

User and cleaning  
protocole



**PRATICIMA**  
healthcare solutions

# ▶ Cleaning protocols

---

Remove glue from dental prosthesis before each cleaning.



## DAILY PROTOCOL

Usage: cleaning

Utilisation: daily

Cleaning time: 2 minutes

Product to use: C2S Tab effervescent sodium bicarbonate tablet



## MEDICATED PROTOCOL

*(in consultation with coordinating physician)*

Usage: cleaning of prostheses with mycoses

Utilisation: ponctual

Cleaning time: 10 minutes

Product to use: pure chlorhexidine

# ► Instructions for use for one single prosthesis

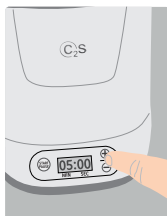
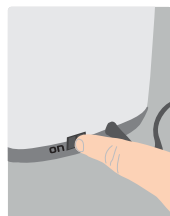
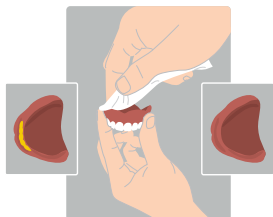
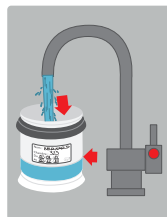
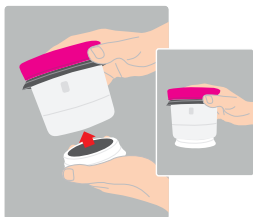

## ► Instructions for use for two prostheses

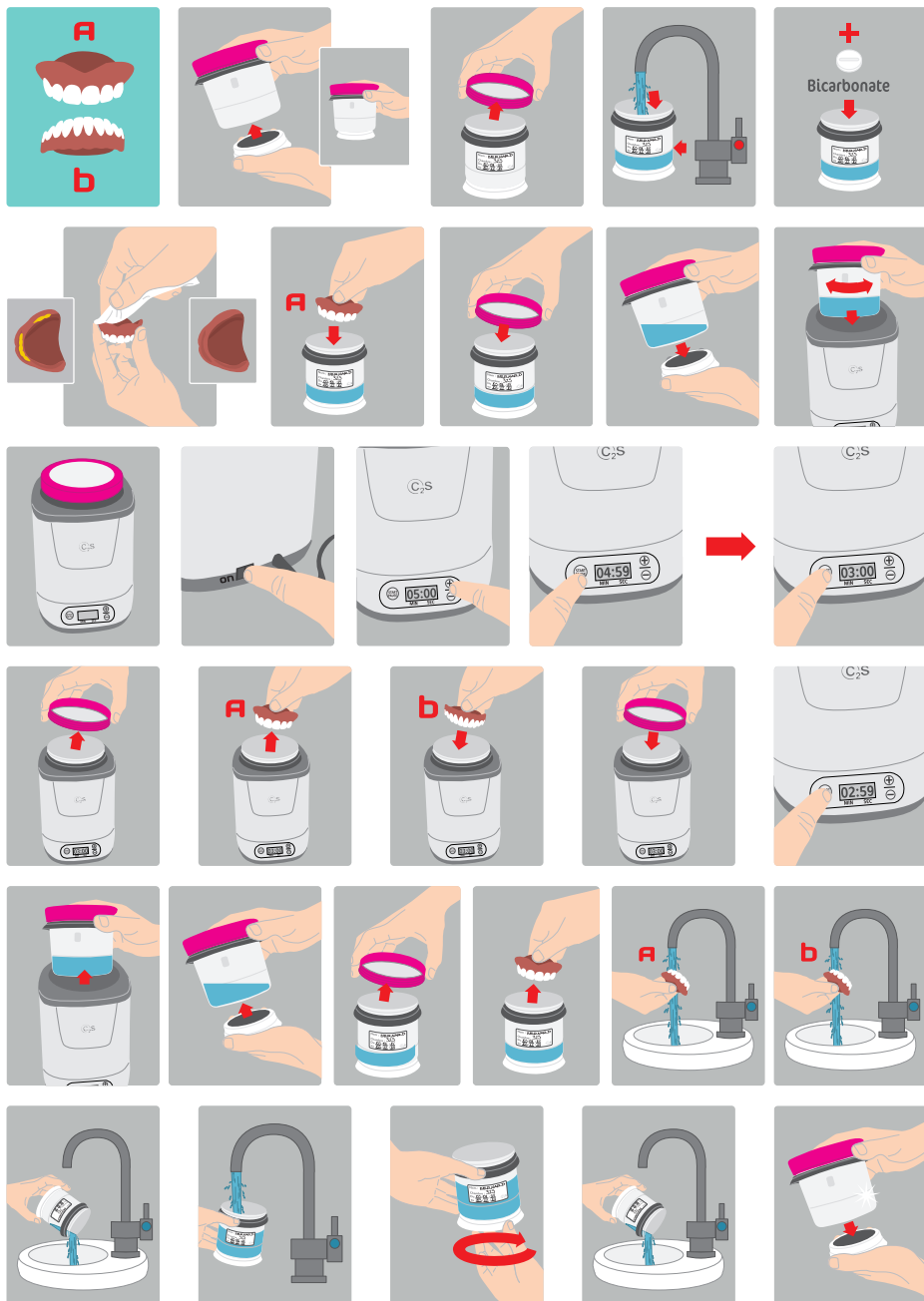

## ► Medical protocol in case of mycosis



It is necessary to solicit the advice of the coordinating physician for this protocol.

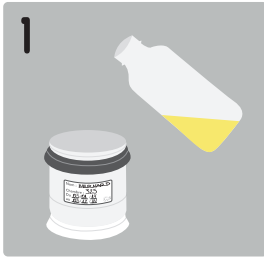

Pour Chlorexidine-based mouthwash into the bowl.

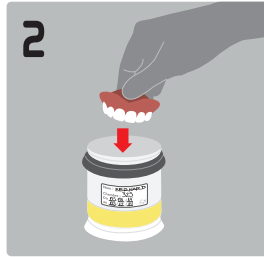

Place the prosthesis into the bowl (cleaning box).



Start cleaning for 10 minutes.

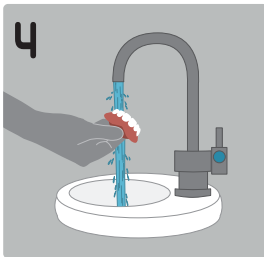

Rinse the prosthese thoroughly with plenty of water.

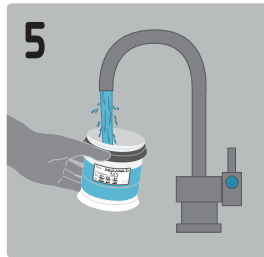

Rinse the bowl (cleaning box) thoroughly with plenty of water.

# ▶ User protocol for C2S Bat Battery



Before first use, it is necessary to load your battery.

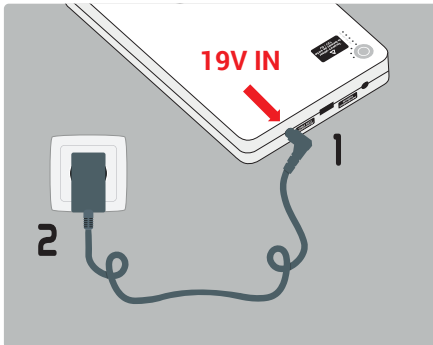

Connect the supplied standard adapter to the «19V IN» port of the battery supply. Connect the charging plug to your electrical installation.

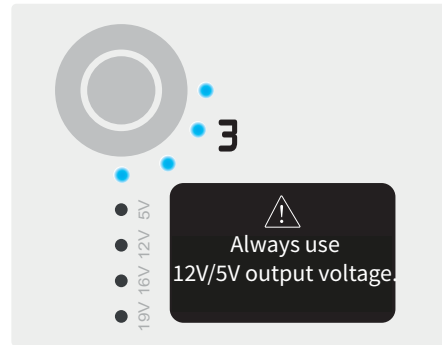

When charging the battery, the blue LEDs blink. The battery is fully charged when all LEDs are fixed and lit.

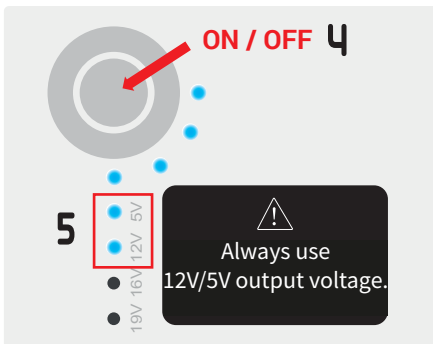

Turn on the battery by a long press on the button ON/OFF then check if it's on the position 12V/5V. If this is not the case, press the button twice to change the output voltage. Repeat until 12V/5V is reached.

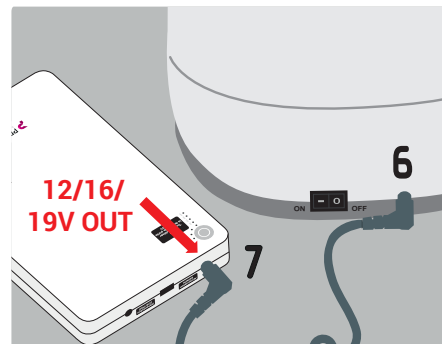

Connect the C2S Pro system to the battery with the provided cable. Then connect the cable to the battery on the output «12/16/19V OUT». **The C2S Pro system is now autonomous.**



# PRATICIMA

healthcare solutions

---

Rue du Pou du Ciel  
ZI de Reyrieux – CS20129 Reyrieux  
01600 TRÉVOUX – FRANCE  
Tél: 04 74 00 98 11 – Fax: 04 74 00 98 36  
E-mail: [praticima@praticima.fr](mailto:praticima@praticima.fr)

[www.praticima.fr](http://www.praticima.fr)