

Accessories and equipment

Neop® Lock motorized curtain door

Non-contractual photos

PRATICIMA offers trolleys equipped with **Neop® Lock, a motorized curtain door with automatic closing and badge access management.**

This innovative system considerably improves the ergonomics of the caregivers' workstation, because all you have to do is badge to open or close the trolley. This reduces repetitive handling and prevents bad posture, thus facilitating the daily tasks of users.

Neop® Lock includes a timer function that guarantees automatic closing of the trolley after a certain period of inactivity. Thanks to the management of access by name badge, you can precisely control who has access to the trolley.

This unique solution allows you to secure the contents of your trolley and **reduce the risk of theft while improving the working comfort of the nursing staff.**



 **Neop
Lock**



Secure



Ergonomic

Benefits

- ▶ Enhanced security: badge access management
- ▶ Ease of use: avoids repetitive handling of the curtain
- ▶ Automatic closing with time delay
- ▶ Anti-pinch system
- ▶ Curtain disengagement in degraded mode

Accessories and equipment

Neop® Lock motorized curtain door

Components

Neop® Lock is designed to integrate exclusively with Neop® trolleys 600 x 400 H. 100 cm.

- ▶ Dimensions of the trolley with the option: L. 883 x D. 583 x H. 1115 mm
- ▶ Cart weight with option: 30,5 kg (24 + 6,5)

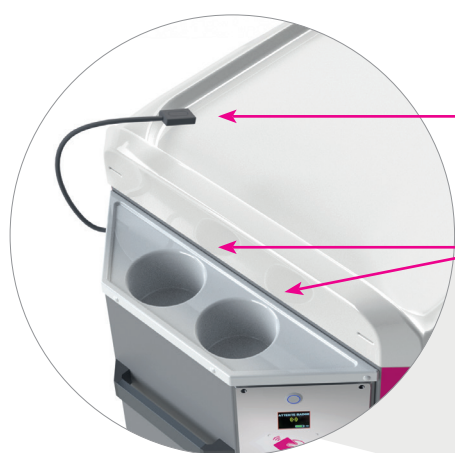

LED reading lamp
with 3 intensity levels:
comfort for night care

Bottle holder



LED strip for interior lighting of the trolley:
lighting synchronized with the opening of
the curtain door

Standard rail
for accessory

Outlet for charging
the trolley



Neop® Lock power button

Control screen:
- Badge: authorized / refused
- Battery charge level
- User badge pairing

Badging area (RFID Mifare)

Neop® Lock motorized curtain door

Mode of use

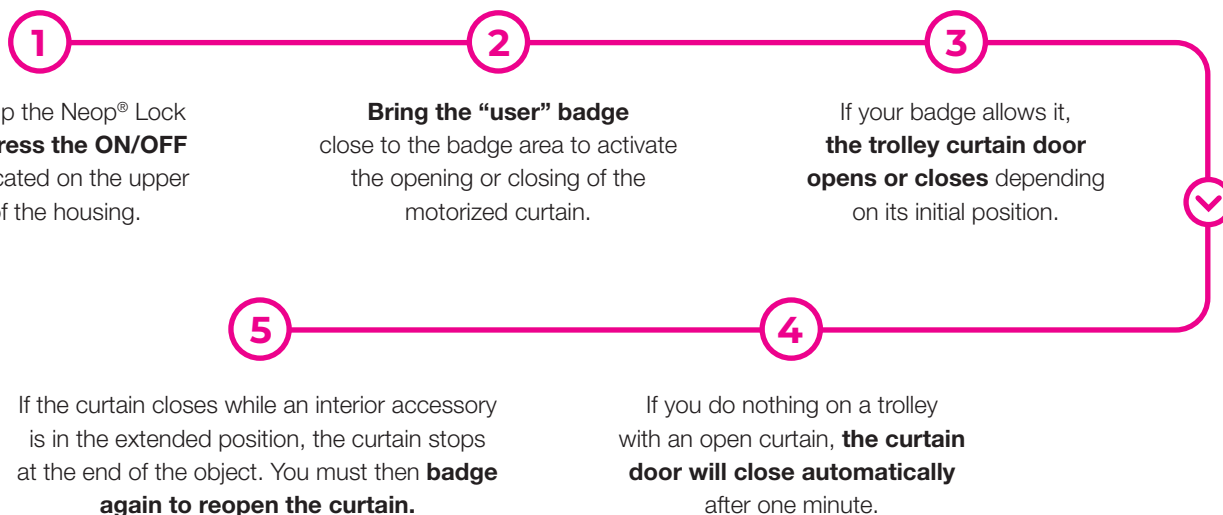

Badge settings

Neop® Lock is compatible with Mifare RFID cards. These contactless smart cards are used for a wide variety of purposes, including access control. **“Master” badges can be configured in two different ways.**

Case #1

A single “Master” badge can authorize the pairing of several “user” cards on several trolleys.

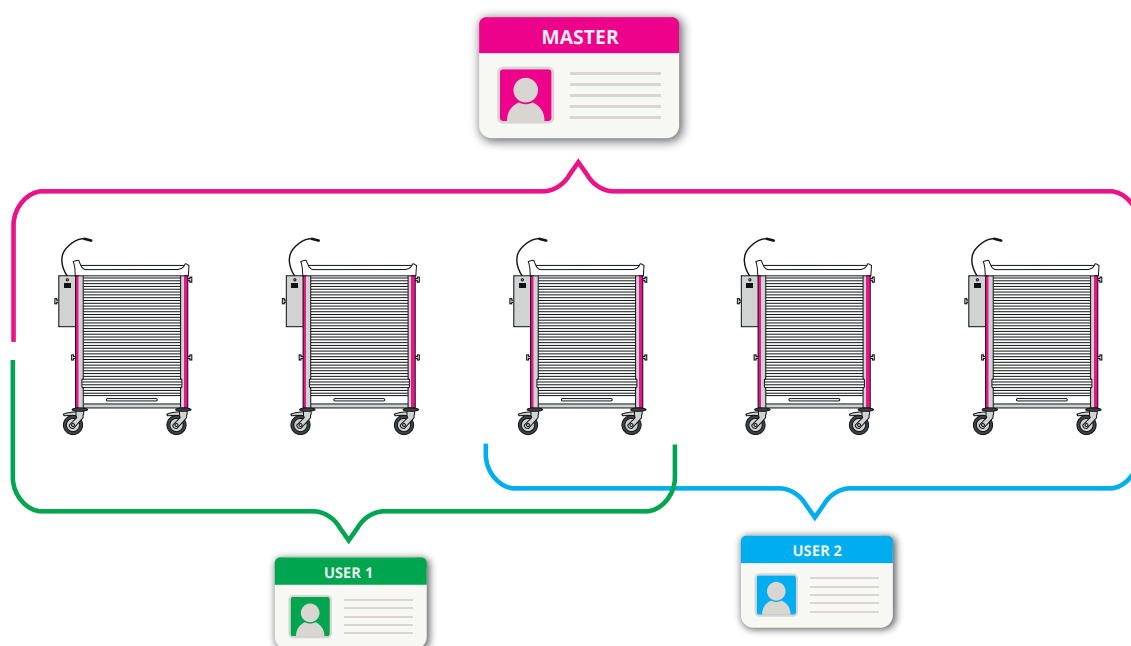

Neop® Lock motorized curtain door

Case #2

A “Master” badge is dedicated to a single cart. It authorizes the pairing of “user” cards only on this one. However, a “user” badge can be associated with several carts.

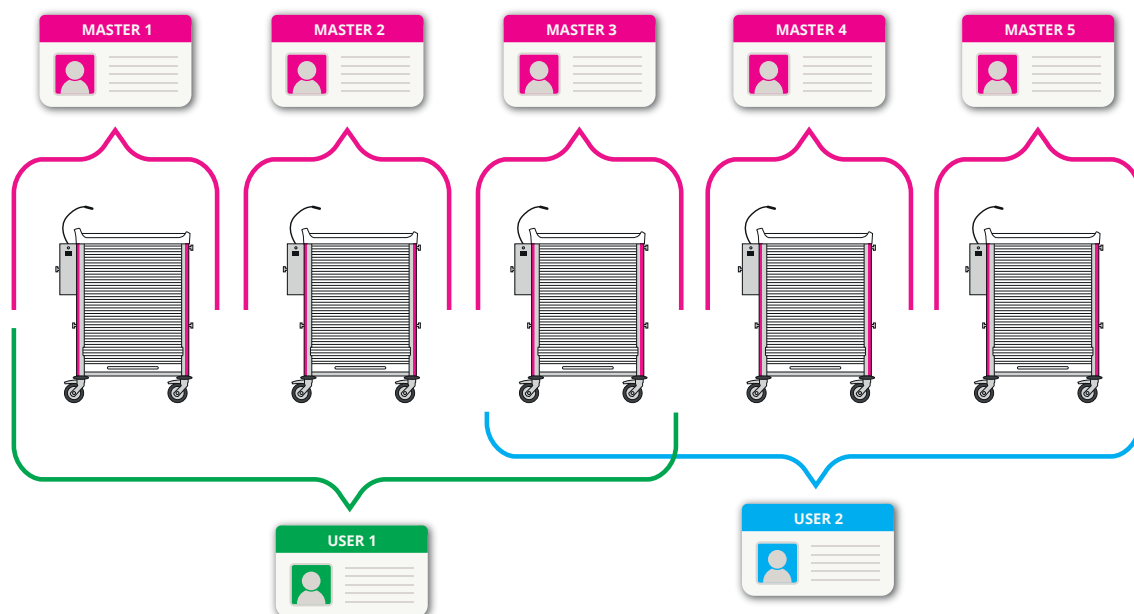

Technical features

Compatibility

- ▶ Neop® trolleys 600 x 400 H. 100 cm
- ▶ “Mifare” communication standard

Curtain door

- ▶ Curtain door release in degraded mode
- ▶ Precise curtain closing with end-of-travel sensor
- ▶ Anti-pinch system according to machine directive standard 2006/42/CE (INRS)

Accessories

- ▶ Integrated LED strip for interior lighting
- ▶ 5V LED reading lamp with 3 intensity levels (USB connection)
- ▶ Bottle holder
- ▶ Standardized rail for accessories fixed to the casing
- ▶ Cable winder

Performance

- ▶ Automatic closing time delay: 1 min
- ▶ Opening time: 5 sec
- ▶ Closing time: 5 sec

Engine

- ▶ Type: 24V 80RPM Geared Motor
- ▶ Nominal speed: 80 RPM
- ▶ Nominal current: 1.4 A
- ▶ Voltage: 24 V - DC

Battery

- ▶ Technology: Lead
- ▶ Number of batteries: 1
- ▶ Voltage: 12 V
- ▶ Capacity: 10 Ah
- ▶ Charging time: 4 h
- ▶ Autonomy: 5 h continuous
- ▶ Standard: IEC 60896-2

Description	Reference
Neop® Lock motorized curtain door	9U000